

1 Proposed Studio Floor  
1/4" = 1'-0"

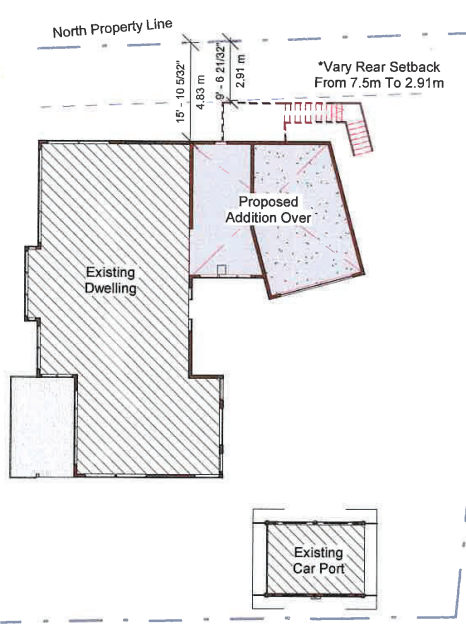

2 Existing Dwelling  
1" = 20'-0"

Existing House Area Calculations:	
Main Floor Area:	1582sq.ft.
Mid Floor Area:	1233sq.ft.
Lower Floor Area:	831sq.ft.
<b>Total:</b>	<b>3646sq.ft.</b>
Garage Area:	349sq.ft.
<b>Proposed Addition</b>	<b>582sq.ft.</b>

PRELIMINARY  
NOT FOR  
CONSTRUCTION

# ODC

OCMANAGEMENT CONSULTANTS  
 MIKE NIELD & JEFF GAGNON  
 LAND & BUILDING DEVELOPMENT CONSULTANTS  
 11522 MILLICAN BLVD. SUITE 200, RICHMOND, BC  
 V6V 2G4, CANADA  
 OFFICE: (604) 273-4944  
 CELL: (604) 273-4944  
 WWW.ODC-CANADA.COM

PROJECT:  
**PROPOSED ADDITION FOR RICHARD & SHARON BLACKWELL**

PROJECT ADDRESS:  
**4855 MILL RD, NARAMATA BC**

START DATE:	03/1/22
ISSUED FOR CLIENT REVIEW:	04/22/22
	04/20/22
	04/12/22
ISSUED FOR DP:	04/26/22
ISSUED FOR PERMIT:	-/22

DESIGNED BY:  
 MIKE NIELD & JEFF GAGNON  
 DRAWN BY:  
 JEFF GAGNON  
 JUSTIN HITCH

SHEET:  
**A2.0**

PLOT DATE:  
 APRIL 26, 2022