

ALL PLUMBING SYSTEMS, FIXTURES & APPLIANCES: to be designed, installed and operated in accordance with the 2018 BC Building Code and 2018 BC Plumbing Code.

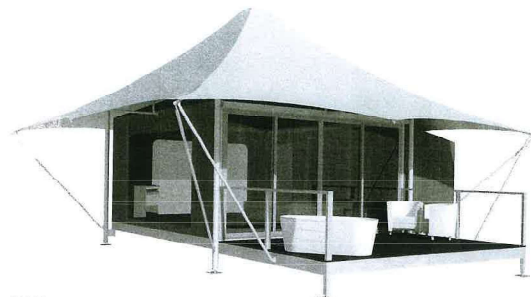

3D VIEW FRONT

Plumbing fixtures to be protected from freezing

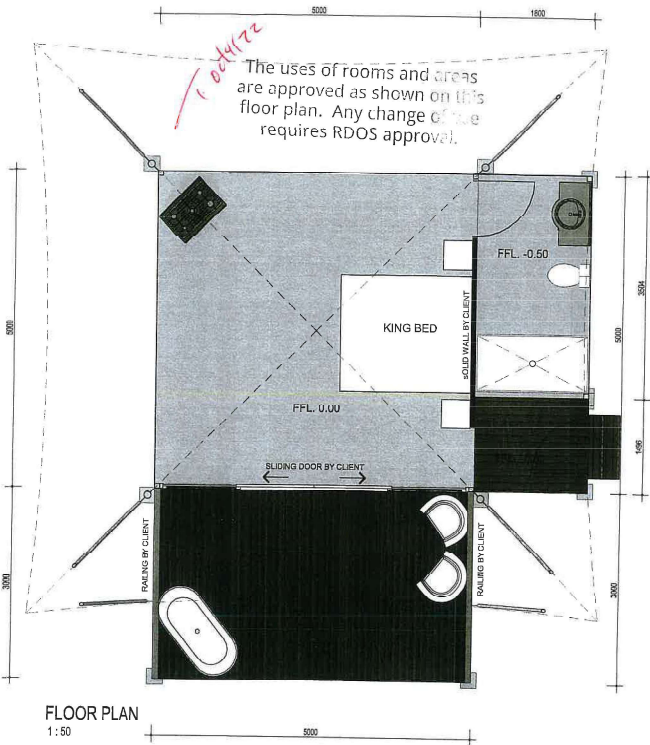
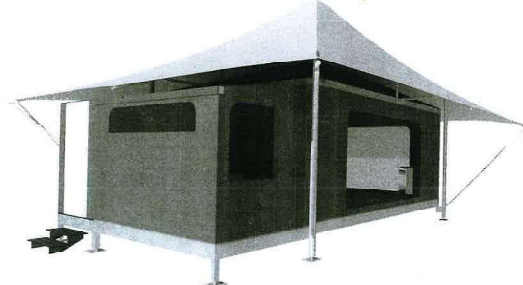

3D VIEW REAR

**OH**  
openhouse

24 Main St Terrace Fernvale Q150  
PO Box 324 South Fernvale Q182  
E: info@openhousegroup.com.au  
W: www.openhousegroup.com.au  
T: +61 8 9112 8000 F: +61 8 9112 2601

**ECO STRUCTURES AUSTRALIA**  
ESTD 2016

REVISION SCHEDULE		
REV	DATE	DESCRIPTION
A	06.22.20	FOR INFO
B	06.21.20	LAYOUT CHANGE

PROJECT:  
Nighthawk Vineyards  
ADDRESS:  
2735 Green Lake Road, Okanagan Falls, BC V0H 1R2

DRAWN FOR:  
ECO STRUCTURES AUSTRALIA  
CLIENT:  
Daniel Gibby & Christy Gibby

- THIS DRAWING IS THE PROPERTY OF OPENHOUSE DESIGN (AN 14 548 213 076) & CO. ANY REUSE OR REPRODUCTION OF THIS DRAWING WITHOUT THE WRITTEN PERMISSION OF OPENHOUSE DESIGN IS STRICTLY PROHIBITED.
- THIS DRAWING IS A PRELIMINARY DESIGN AND SHOULD NOT BE USED FOR ANY OTHER PURPOSE THAN ORIGINAL DESIGN.
- DESIGNER IS NOT RESPONSIBLE FOR THE ACCURACY OF ANY INFORMATION PROVIDED BY THE CLIENT OR ANY OTHER PARTY.
- THIS DRAWING IS TO BE USED IN CONJUNCTION WITH ALL APPLICABLE LOCAL, STATE, FEDERAL, AND INTERNATIONAL REGULATIONS AND STANDARDS.
- ALL WORKMANSHIP & MATERIALS TO BE IN ACCORDANCE WITH THE MOST CURRENT BUILDING REGULATIONS, S.A.A. CODES & AUSTRALIAN STANDARDS.
- CONCEPTS SHOWN ARE SUBJECT TO RELEVANT AUTHORITY APPROVALS.
- NOT FOR CONSTRUCTION PURPOSES.
- BY TRADING FOR ILLUSTRATIVE PURPOSES ONLY.

PRELIMINARY		
DRAWN	SCALE @ A3	DATE
MS	As Indicated	6/01/2021 1:37:45 PM
PROJECT NO. 40-0244		
DRAWING PLAN & 3D		
DRAWING NO. <b>SK01</b>		REVISION <b>B</b>

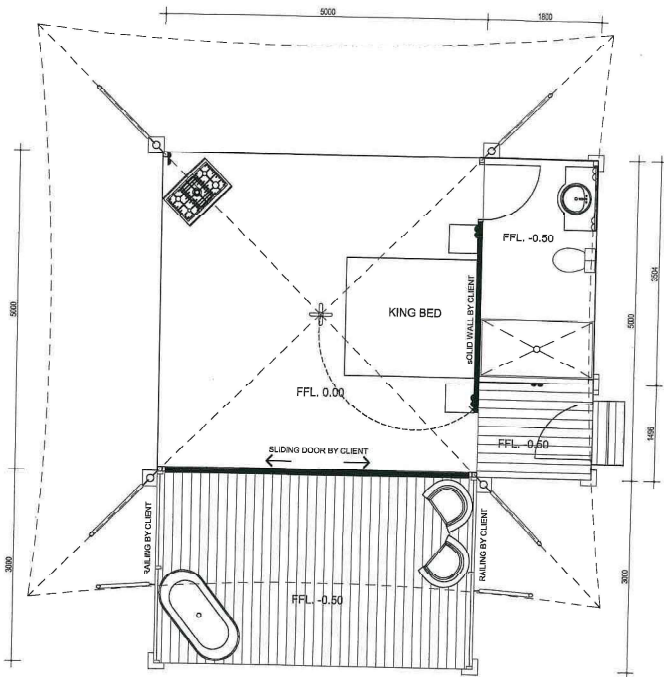

ELECTRICAL LEGEND	
[Symbol]	LOAD CENTRE
[Symbol]	WEATHERPROOF IDF (INTERMEDIATE DISTRIBUTION FRAME)
[Symbol]	WALL LIGHT 1800 ABOVE F.L. (OR AS NOTED)
[Symbol]	WALL LIGHT WITH SENSOR
[Symbol]	SWAYL 80WATT WARM WHITE LIGHT
[Symbol]	DOUBLE FLUORESCENT LIGHT
[Symbol]	FLUORESCENT LIGHT
[Symbol]	EXHAUST FAN (UNFLAMED)
[Symbol]	EXHAUST FAN (FLAMED)
[Symbol]	DOWNLIGHT FITTING
[Symbol]	CEILING MOUNTED LIGHT FITTING
[Symbol]	DIRECT WIRED SMOKE DETECTOR TO AS 3780
[Symbol]	SINGLE GPO AT 200 A.F.L.
[Symbol]	DOUBLE GPO AT 200 A.F.L.
[Symbol]	SINGLE GPO AT 300 A.F.L. (OR AS NOTED)
[Symbol]	DOUBLE GPO AT 300 A.F.L. (OR AS NOTED)
[Symbol]	CEILING FAN
[Symbol]	COMBINATION FAN (LIGHT/HEATER) (FLAMED)
[Symbol]	WEATHERPROOF ODOP 1000 A.F.L. (OR AS NOTED)
[Symbol]	PENDANT LIGHT
[Symbol]	CEILING VENT (FLAMED)
[Symbol]	CEILING VENT (UNFLAMED)
[Symbol]	PHONE POINT 200 A.F.L. (OR AS NOTED)
[Symbol]	DATA POINT 2750 A.F.L. (OR AS NOTED)
[Symbol]	TV POINT 200 A.F.L. (OR AS NOTED)
[Symbol]	TV POINT 1500 A.F.L. (OR AS NOTED)
[Symbol]	WP ISOLATOR (SWITCH) 1500 A.F.L. (OR AS NOTED)
[Symbol]	WP ISOLATOR (SWITCH) 200 A.F.L. (OR AS NOTED)
[Symbol]	WP ISOLATOR (SWITCH) 300 A.F.L. (OR AS NOTED)
[Symbol]	WP ISOLATOR (SWITCH) 400 A.F.L. (OR AS NOTED)
[Symbol]	WP ISOLATOR (SWITCH) 500 A.F.L. (OR AS NOTED)
[Symbol]	WP ISOLATOR (SWITCH) 600 A.F.L. (OR AS NOTED)
[Symbol]	WP ISOLATOR (SWITCH) 700 A.F.L. (OR AS NOTED)
[Symbol]	WP ISOLATOR (SWITCH) 800 A.F.L. (OR AS NOTED)
[Symbol]	WP ISOLATOR (SWITCH) 900 A.F.L. (OR AS NOTED)
[Symbol]	WP ISOLATOR (SWITCH) 1000 A.F.L. (OR AS NOTED)
[Symbol]	WP ISOLATOR (SWITCH) 1100 A.F.L. (OR AS NOTED)
[Symbol]	WP ISOLATOR (SWITCH) 1200 A.F.L. (OR AS NOTED)
[Symbol]	WP ISOLATOR (SWITCH) 1300 A.F.L. (OR AS NOTED)
[Symbol]	WP ISOLATOR (SWITCH) 1400 A.F.L. (OR AS NOTED)
[Symbol]	WP ISOLATOR (SWITCH) 1500 A.F.L. (OR AS NOTED)
[Symbol]	WP ISOLATOR (SWITCH) 1600 A.F.L. (OR AS NOTED)
[Symbol]	WP ISOLATOR (SWITCH) 1700 A.F.L. (OR AS NOTED)
[Symbol]	WP ISOLATOR (SWITCH) 1800 A.F.L. (OR AS NOTED)
[Symbol]	WP ISOLATOR (SWITCH) 1900 A.F.L. (OR AS NOTED)
[Symbol]	WP ISOLATOR (SWITCH) 2000 A.F.L. (OR AS NOTED)
[Symbol]	WP ISOLATOR (SWITCH) 2100 A.F.L. (OR AS NOTED)
[Symbol]	WP ISOLATOR (SWITCH) 2200 A.F.L. (OR AS NOTED)
[Symbol]	WP ISOLATOR (SWITCH) 2300 A.F.L. (OR AS NOTED)
[Symbol]	WP ISOLATOR (SWITCH) 2400 A.F.L. (OR AS NOTED)
[Symbol]	WP ISOLATOR (SWITCH) 2500 A.F.L. (OR AS NOTED)
[Symbol]	WP ISOLATOR (SWITCH) 2600 A.F.L. (OR AS NOTED)
[Symbol]	WP ISOLATOR (SWITCH) 2700 A.F.L. (OR AS NOTED)
[Symbol]	WP ISOLATOR (SWITCH) 2800 A.F.L. (OR AS NOTED)
[Symbol]	WP ISOLATOR (SWITCH) 2900 A.F.L. (OR AS NOTED)
[Symbol]	WP ISOLATOR (SWITCH) 3000 A.F.L. (OR AS NOTED)
[Symbol]	WP ISOLATOR (SWITCH) 3100 A.F.L. (OR AS NOTED)
[Symbol]	WP ISOLATOR (SWITCH) 3200 A.F.L. (OR AS NOTED)
[Symbol]	WP ISOLATOR (SWITCH) 3300 A.F.L. (OR AS NOTED)
[Symbol]	WP ISOLATOR (SWITCH) 3400 A.F.L. (OR AS NOTED)
[Symbol]	WP ISOLATOR (SWITCH) 3500 A.F.L. (OR AS NOTED)
[Symbol]	WP ISOLATOR (SWITCH) 3600 A.F.L. (OR AS NOTED)
[Symbol]	WP ISOLATOR (SWITCH) 3700 A.F.L. (OR AS NOTED)
[Symbol]	WP ISOLATOR (SWITCH) 3800 A.F.L. (OR AS NOTED)
[Symbol]	WP ISOLATOR (SWITCH) 3900 A.F.L. (OR AS NOTED)
[Symbol]	WP ISOLATOR (SWITCH) 4000 A.F.L. (OR AS NOTED)
[Symbol]	WP ISOLATOR (SWITCH) 4100 A.F.L. (OR AS NOTED)
[Symbol]	WP ISOLATOR (SWITCH) 4200 A.F.L. (OR AS NOTED)
[Symbol]	WP ISOLATOR (SWITCH) 4300 A.F.L. (OR AS NOTED)
[Symbol]	WP ISOLATOR (SWITCH) 4400 A.F.L. (OR AS NOTED)
[Symbol]	WP ISOLATOR (SWITCH) 4500 A.F.L. (OR AS NOTED)
[Symbol]	WP ISOLATOR (SWITCH) 4600 A.F.L. (OR AS NOTED)
[Symbol]	WP ISOLATOR (SWITCH) 4700 A.F.L. (OR AS NOTED)
[Symbol]	WP ISOLATOR (SWITCH) 4800 A.F.L. (OR AS NOTED)
[Symbol]	WP ISOLATOR (SWITCH) 4900 A.F.L. (OR AS NOTED)
[Symbol]	WP ISOLATOR (SWITCH) 5000 A.F.L. (OR AS NOTED)
[Symbol]	WP ISOLATOR (SWITCH) 5100 A.F.L. (OR AS NOTED)
[Symbol]	WP ISOLATOR (SWITCH) 5200 A.F.L. (OR AS NOTED)
[Symbol]	WP ISOLATOR (SWITCH) 5300 A.F.L. (OR AS NOTED)
[Symbol]	WP ISOLATOR (SWITCH) 5400 A.F.L. (OR AS NOTED)
[Symbol]	WP ISOLATOR (SWITCH) 5500 A.F.L. (OR AS NOTED)
[Symbol]	WP ISOLATOR (SWITCH) 5600 A.F.L. (OR AS NOTED)
[Symbol]	WP ISOLATOR (SWITCH) 5700 A.F.L. (OR AS NOTED)
[Symbol]	WP ISOLATOR (SWITCH) 5800 A.F.L. (OR AS NOTED)
[Symbol]	WP ISOLATOR (SWITCH) 5900 A.F.L. (OR AS NOTED)
[Symbol]	WP ISOLATOR (SWITCH) 6000 A.F.L. (OR AS NOTED)
[Symbol]	WP ISOLATOR (SWITCH) 6100 A.F.L. (OR AS NOTED)
[Symbol]	WP ISOLATOR (SWITCH) 6200 A.F.L. (OR AS NOTED)
[Symbol]	WP ISOLATOR (SWITCH) 6300 A.F.L. (OR AS NOTED)
[Symbol]	WP ISOLATOR (SWITCH) 6400 A.F.L. (OR AS NOTED)
[Symbol]	WP ISOLATOR (SWITCH) 6500 A.F.L. (OR AS NOTED)
[Symbol]	WP ISOLATOR (SWITCH) 6600 A.F.L. (OR AS NOTED)
[Symbol]	WP ISOLATOR (SWITCH) 6700 A.F.L. (OR AS NOTED)
[Symbol]	WP ISOLATOR (SWITCH) 6800 A.F.L. (OR AS NOTED)
[Symbol]	WP ISOLATOR (SWITCH) 6900 A.F.L. (OR AS NOTED)
[Symbol]	WP ISOLATOR (SWITCH) 7000 A.F.L. (OR AS NOTED)
[Symbol]	WP ISOLATOR (SWITCH) 7100 A.F.L. (OR AS NOTED)
[Symbol]	WP ISOLATOR (SWITCH) 7200 A.F.L. (OR AS NOTED)
[Symbol]	WP ISOLATOR (SWITCH) 7300 A.F.L. (OR AS NOTED)
[Symbol]	WP ISOLATOR (SWITCH) 7400 A.F.L. (OR AS NOTED)
[Symbol]	WP ISOLATOR (SWITCH) 7500 A.F.L. (OR AS NOTED)
[Symbol]	WP ISOLATOR (SWITCH) 7600 A.F.L. (OR AS NOTED)
[Symbol]	WP ISOLATOR (SWITCH) 7700 A.F.L. (OR AS NOTED)
[Symbol]	WP ISOLATOR (SWITCH) 7800 A.F.L. (OR AS NOTED)
[Symbol]	WP ISOLATOR (SWITCH) 7900 A.F.L. (OR AS NOTED)
[Symbol]	WP ISOLATOR (SWITCH) 8000 A.F.L. (OR AS NOTED)
[Symbol]	WP ISOLATOR (SWITCH) 8100 A.F.L. (OR AS NOTED)
[Symbol]	WP ISOLATOR (SWITCH) 8200 A.F.L. (OR AS NOTED)
[Symbol]	WP ISOLATOR (SWITCH) 8300 A.F.L. (OR AS NOTED)
[Symbol]	WP ISOLATOR (SWITCH) 8400 A.F.L. (OR AS NOTED)
[Symbol]	WP ISOLATOR (SWITCH) 8500 A.F.L. (OR AS NOTED)
[Symbol]	WP ISOLATOR (SWITCH) 8600 A.F.L. (OR AS NOTED)
[Symbol]	WP ISOLATOR (SWITCH) 8700 A.F.L. (OR AS NOTED)
[Symbol]	WP ISOLATOR (SWITCH) 8800 A.F.L. (OR AS NOTED)
[Symbol]	WP ISOLATOR (SWITCH) 8900 A.F.L. (OR AS NOTED)
[Symbol]	WP ISOLATOR (SWITCH) 9000 A.F.L. (OR AS NOTED)
[Symbol]	WP ISOLATOR (SWITCH) 9100 A.F.L. (OR AS NOTED)
[Symbol]	WP ISOLATOR (SWITCH) 9200 A.F.L. (OR AS NOTED)
[Symbol]	WP ISOLATOR (SWITCH) 9300 A.F.L. (OR AS NOTED)
[Symbol]	WP ISOLATOR (SWITCH) 9400 A.F.L. (OR AS NOTED)
[Symbol]	WP ISOLATOR (SWITCH) 9500 A.F.L. (OR AS NOTED)
[Symbol]	WP ISOLATOR (SWITCH) 9600 A.F.L. (OR AS NOTED)
[Symbol]	WP ISOLATOR (SWITCH) 9700 A.F.L. (OR AS NOTED)
[Symbol]	WP ISOLATOR (SWITCH) 9800 A.F.L. (OR AS NOTED)
[Symbol]	WP ISOLATOR (SWITCH) 9900 A.F.L. (OR AS NOTED)
[Symbol]	WP ISOLATOR (SWITCH) 10000 A.F.L. (OR AS NOTED)

**Smoke Alarms 9.10.19. Location of Smoke Alarms**  
 Within dwelling units, sufficient smoke alarms shall be installed so that there is a least one smoke alarm on each storey, including basements, and a smoke alarm is installed in each sleeping room, and in a location between the sleeping rooms and the remainder of the storey, and if the sleeping rooms are served by a hallway, the smoke alarm shall be located in the hallway. To be interconnected, hard wired and c/w battery backup. Manual device to silence alarm not more than 10min. and will reset; instructions for maintenance and care of smoke alarms to be posted in a location readily available to occupants for reference.

1 ELECTRICAL PLAN  
1:50

ELECTRICAL LEGEND  
1:100

	24 Marine Terrace, Fort St. John, BC 250-504-8044 www.openhousebc.com		<b>REVISION SCHEDULE</b> <table border="1"> <thead> <tr> <th>REV.</th> <th>DATE</th> <th>DESCRIPTION</th> </tr> </thead> <tbody> <tr> <td>A</td> <td>06.05.20</td> <td>FOR INFO</td> </tr> </tbody> </table>	REV.	DATE	DESCRIPTION	A	06.05.20	FOR INFO	<b>PROJECT:</b> Nighthawk Vineyards <b>ADDRESS:</b> 2735 Green Lake Road, Okanagan Falls, BC V0H 1R2	1. THIS DRAWING IS COPYRIGHTED BY OPENHOUSE DESIGN AND THE PROPERTY OF OPENHOUSE DESIGN. IT IS NOT TO BE REPRODUCED OR TRANSMITTED IN ANY FORM OR BY ANY MEANS, ELECTRONIC OR MECHANICAL, INCLUDING PHOTOCOPYING, RECORDING, OR BY ANY INFORMATION STORAGE AND RETRIEVAL SYSTEM, WITHOUT THE WRITTEN PERMISSION OF OPENHOUSE DESIGN. 2. THIS DRAWING IS FOR INFORMATION PURPOSES ONLY. IT IS NOT TO BE USED FOR ANY OTHER PURPOSE THAN ORIGINALLY INTENDED. 3. THE DRAWING IS THE PROPERTY OF OPENHOUSE DESIGN AND IS NOT TO BE REPRODUCED OR TRANSMITTED IN ANY FORM OR BY ANY MEANS, ELECTRONIC OR MECHANICAL, INCLUDING PHOTOCOPYING, RECORDING, OR BY ANY INFORMATION STORAGE AND RETRIEVAL SYSTEM, WITHOUT THE WRITTEN PERMISSION OF OPENHOUSE DESIGN. 4. THE DRAWING IS THE PROPERTY OF OPENHOUSE DESIGN AND IS NOT TO BE REPRODUCED OR TRANSMITTED IN ANY FORM OR BY ANY MEANS, ELECTRONIC OR MECHANICAL, INCLUDING PHOTOCOPYING, RECORDING, OR BY ANY INFORMATION STORAGE AND RETRIEVAL SYSTEM, WITHOUT THE WRITTEN PERMISSION OF OPENHOUSE DESIGN. 5. ALL MATERIALS AND METHODS TO BE USED SHALL BE AS SPECIFIED IN THE DRAWING. 6. THE DRAWING IS THE PROPERTY OF OPENHOUSE DESIGN AND IS NOT TO BE REPRODUCED OR TRANSMITTED IN ANY FORM OR BY ANY MEANS, ELECTRONIC OR MECHANICAL, INCLUDING PHOTOCOPYING, RECORDING, OR BY ANY INFORMATION STORAGE AND RETRIEVAL SYSTEM, WITHOUT THE WRITTEN PERMISSION OF OPENHOUSE DESIGN. 7. THE DRAWING IS THE PROPERTY OF OPENHOUSE DESIGN AND IS NOT TO BE REPRODUCED OR TRANSMITTED IN ANY FORM OR BY ANY MEANS, ELECTRONIC OR MECHANICAL, INCLUDING PHOTOCOPYING, RECORDING, OR BY ANY INFORMATION STORAGE AND RETRIEVAL SYSTEM, WITHOUT THE WRITTEN PERMISSION OF OPENHOUSE DESIGN. 8. THE DRAWING IS THE PROPERTY OF OPENHOUSE DESIGN AND IS NOT TO BE REPRODUCED OR TRANSMITTED IN ANY FORM OR BY ANY MEANS, ELECTRONIC OR MECHANICAL, INCLUDING PHOTOCOPYING, RECORDING, OR BY ANY INFORMATION STORAGE AND RETRIEVAL SYSTEM, WITHOUT THE WRITTEN PERMISSION OF OPENHOUSE DESIGN. 9. THE DRAWING IS THE PROPERTY OF OPENHOUSE DESIGN AND IS NOT TO BE REPRODUCED OR TRANSMITTED IN ANY FORM OR BY ANY MEANS, ELECTRONIC OR MECHANICAL, INCLUDING PHOTOCOPYING, RECORDING, OR BY ANY INFORMATION STORAGE AND RETRIEVAL SYSTEM, WITHOUT THE WRITTEN PERMISSION OF OPENHOUSE DESIGN. 10. THE DRAWING IS THE PROPERTY OF OPENHOUSE DESIGN AND IS NOT TO BE REPRODUCED OR TRANSMITTED IN ANY FORM OR BY ANY MEANS, ELECTRONIC OR MECHANICAL, INCLUDING PHOTOCOPYING, RECORDING, OR BY ANY INFORMATION STORAGE AND RETRIEVAL SYSTEM, WITHOUT THE WRITTEN PERMISSION OF OPENHOUSE DESIGN.	<b>PRELIMINARY</b> DRAWN: Author SCALE: AS SHOWN DATE: AS INDICATED PROJECT NO. 40-0544 DRAWING NO. ELECTRICAL PLAN DRAWING NO. SK02 REVISION A
			REV.	DATE	DESCRIPTION							
A	06.05.20	FOR INFO										
<b>DRAWN FOR:</b> Designer CLIENT: Daniel Bibby & Christy Bibby												